

- Total Building - 3,840 s.f.**
- Unit A - LEASED
 - Car Parking 8 spaces
 - Truck Parking 6 spaces
 - Unit B - 1,280 s.f. +/- Available
 - Unit C - 1,280 s.f. +/- Available
 - Available Straight Truck Parking

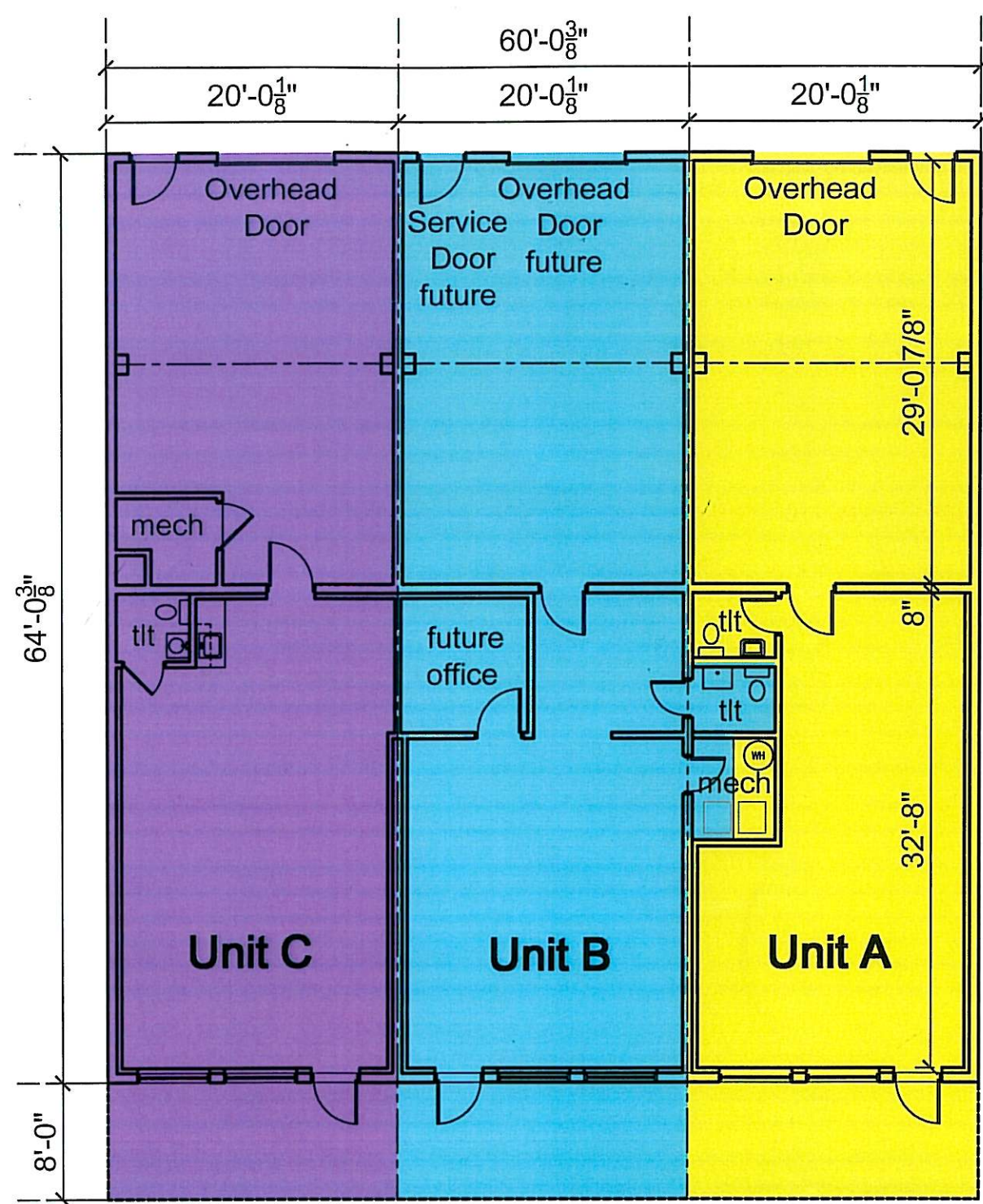

Building Plan
 Scale $\frac{3}{32} = 1'-0"$

Site Plan
 Scale: 1"=30'

Site & Building Plan - Unit A, B & C

1215 West Irving Park Road
 Itasca, IL

December 15, 2014



GULLO INTERNATIONAL
 DEVELOPMENT CORPORATION
 1100 Landreder Road
 Elk Grove Village, IL 60007
 Phone 847.364.7000
 Fax 847.364.7030